



# US Echo II

Ultrasonic Flow Meter Qp 0.6-15 m<sup>3</sup>/h

US ECHO II is the standard for highly accurate flow meters. Issued from CF Heat Meter's family, US ECHO II easily adapts its self to different types of calculators. Its powerful electronics enables any user to take advantage of all state of the art functions maintaining an extraordinary high precision throughout the entire measurement curve.

Flows are measured from 6 L/h up to 33 m<sup>3</sup>/h for different piping going from DN15 up DN50. All flows exist for PN25 applications.

## FEATURES AND BENEFITS

- » High Accuracy
- » Robustness
- » Ease of Installation
- » Self Management
- » Repeatability over time
- » Robustness
- » Reliability
- » Diagnostic functions

CE type approval certificate:  
DE-06-MI004-PTB008

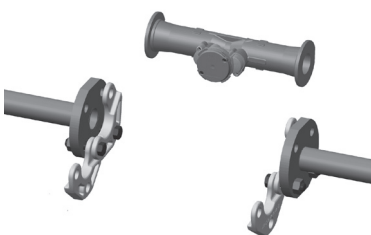

NEW! Movable flanges for easy installation directly at the meter body.

## Applications

Heating and/or cooling installations for horizontal or vertical mounting.

## Standards Compliance

- » MID 2014/32/EU Module B+D
- » Class 2.0 acc. EN 1434
- » Env. Class E1, M1 acc. 2014/32/EU
- » PED compliance

## DIMENSIONS

See Technical Characteristics table for available lengths.

DN	15	20	25	32	40	50
A	72	72	77	77	85	85
B	18	18	23	24	35	-
D <sub>o</sub> (flanges)	-	100	100	-	140	160

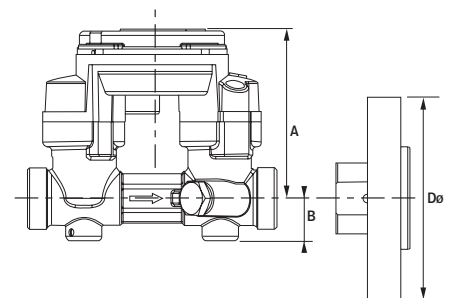

## HEAD LOSS

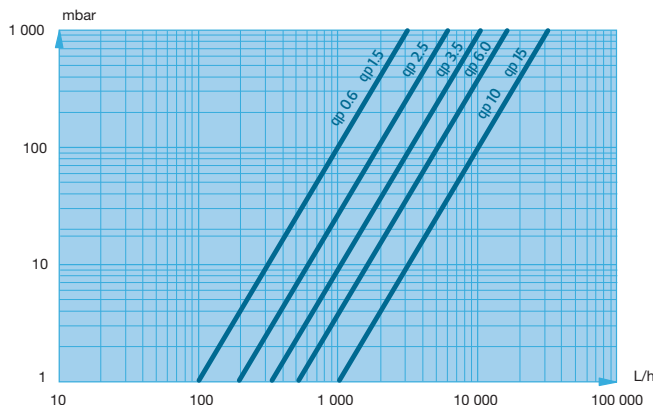

## Technical Characteristics

Nominal Flow Qp m <sup>3</sup> /h	Diameter DN mm	Max flow Qs m <sup>3</sup> /h	Min flow Qs L/h	Start flow Qstart L/h	Body length mm	Pipe Connection	Nominal Pressure bar	Permanent max. temp. °C	Accidental max. temp. °C
0.6	15	1.2	6	1.2	110	G ¾ B	16/25	130	150
	20	1.2	6	1.2	130	G 1 B	16/25	130	150
	20	1.2	6	1.2	190	G 1 B / flanges	16/25	130	150
1.5	15	3	15	3	110	G ¾ B	16/25	130	150
	20	3	15	3	130	G 1 B	16/25	130	150
	20	3	15	3	190	G 1 B / flanges	16/25	130	150
2.5	20	5	25	5	130	G 1 B	16/25	130	150
	20	5	25	5	190	G 1 B / flanges	16/25	130	150
	25	5	25	5	260	G 1 ¼ B	16/25	130	150
3.5	25	7	35	7	150	G 1 ¼ B	16/25	130	150
	25	7	35	7	260	G 1 ¼ B / flanges	16/25	130	150
	40	7	35	7	300	Flanges	25	130	150
6	25	12	60	12	150	G 1 ¼ B	16/25	130	150
	25	12	60	12	260	G 1 ¼ B / flanges	16/25	130	150
	32	12	60	12	260	G 1 ½ B	16/25	130	150
	40	12	60	12	300	Flanges	25	130	150
	50	12	60	12	270	Flanges	25	130	150
10	40	20	100	20	200	G 2 B	16/25	130	150
	40	20	100	20	250	Flanges	25	130	150
	40	20	100	20	300	G 2 B / flanges	16/25	130	150
	50	20	100	20	270	Flanges	25	130	150
15	50	30	150	30	250	Flanges	25	130	150
	50	30	150	30	270	Flanges	25	130	150

Pulse Value (Qp)	Pulses (L/p)	Test Pulses (cm <sup>3</sup> /p)
0.6	1, 2.5, 10, 25, 100, 250	5
1.5	1, 2.5, 10, 25, 100, 250	10
2.5	1, 2.5, 10, 25, 100, 250	20
3.5	1, 2.5, 10, 25, 100, 250	25
6	1, 2.5, 10, 25, 100, 250	50
10	1, 2.5, 10, 25, 100, 250	100
15	1, 2.5, 10, 25, 100, 250	100



Join us in creating a more **resourceful world**.  
To learn more visit **itron.com**

While Itron strives to make the content of its marketing materials as timely and accurate as possible, Itron makes no claims, promises, or guarantees about the accuracy, completeness, or adequacy of, and expressly disclaims liability for errors and omissions in, such materials. No warranty of any kind, implied, expressed, or statutory, including but not limited to the warranties of non-infringement of third party rights, title, merchantability, and fitness for a particular purpose, is given with respect to the content of these marketing materials. © Copyright 2017 Itron. All rights reserved. **HE-0017.2-EN-05.17**

### ITRON METERING

Allmess GmbH  
Am Voßberg 11  
23758 Oldenburg i.H.  
Germany

**Phone:** +49 4361 625-0  
**Fax:** +49 4361 625-250